

# Harpa Concert Hall and Conference Centre



# Harpa Concert Hall and Conference Centre

## Contact & General information



### Hrafnhildur Svansdóttir

Viðskiptastjóri ráðstefnudeild  
Account Manager Conferences



**Harpa Concert Hall  
& Conference Centre**

hrafnhildur@harpa.is  
**(354) 8581991**  
**(354) 5285000**



## Venue location

- Located right in the city centre of Reykjavík.
- The nearest international airport is Keflavík International Airport, 45 kilometres away.
- Getting to Harpa from the airport will take around 45-50 minutes by car.





# About Harpa

## One of Reykjavik's most striking landmarks

- Harpa is an **award-winning work of art** that has been visited by millions of people since its opening in 2011.
- Harpa is a **centre of cultural and social life** in the very heart of the city of Reykjavik. Located in the harbour district with fine dining restaurants and high-end stores within walking distance.
- Harpa is a world class conference centre that has received **numerous awards and prizes** for outstanding facilities, both for its architecture and as a concert hall and conference centre.

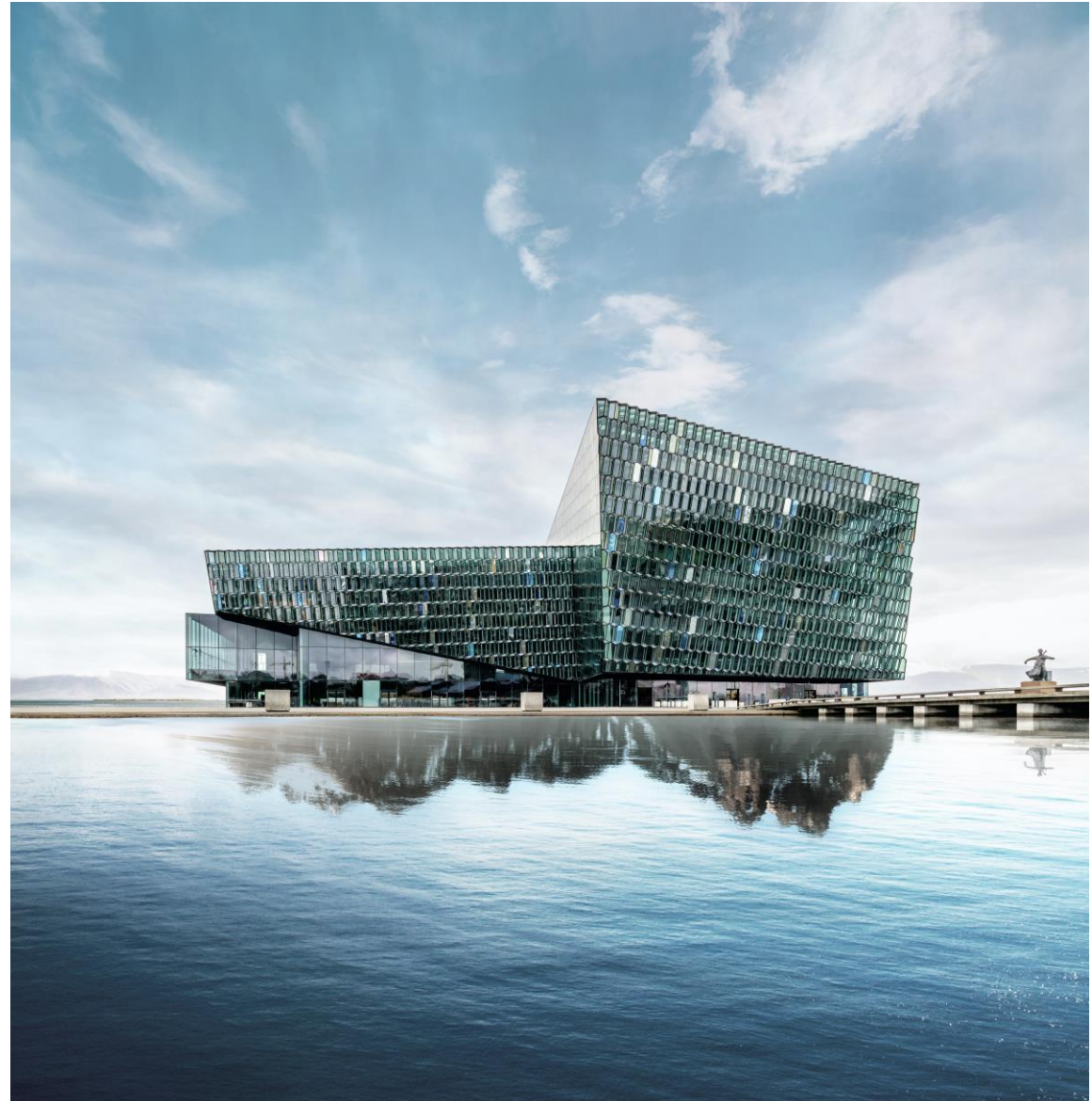







# Harpa's Awards

**2018**

Eldborg was an unbeatable choice by the jury for the USITT Architecture Award for acoustic.

**2016**

The Best Conference Centre in Europe. Award by the Business Destination magazine.

**2013**

The highly respected Mies van der Rohe - European Union Prize for Contemporary Architecture Award.

**2010**

The best concert houses of the new millennium by Gramophone Magazine.

